



## *Small Bay Warehouse Spaces*

358 NW 27th Ave  
Fort Lauderdale, FL 33311

*For Lease*

[martinezteamcommercial.com](http://martinezteamcommercial.com)

Lease a small bay warehouse in a premier destination that's strategically located in the city of Fort Lauderdale, FL. The warehouses are in the heart of a bustling commercial hub. Our warehouse park offers an unparalleled opportunity for businesses seeking a convenient location, flexibility, and a thriving environment.



**Asking Price: \$18.38 PSF Base Rent**

**NNN is \$2.89 PSF**

**The size of the Bays is 1100 SF**

**Type of Property: Warehouse Spaces**

### HIGHLIGHTS

- 3-5 year leases
- Plenty of Paved Yard in the rear for deliveries.
- 12' clear ceilings
- A/C in the front office
- Pride of Ownership

### DEMOGRAPHICS

	2 mile	5 mile	10 mile
2023 Population	71,055	384,700	1,234,314
2023 Households	23,989	154,481	503,373
Average Household Income	\$69,063	\$82,855	\$83,933

358 NW 27th Ave  
Fort Lauderdale, FL 33311

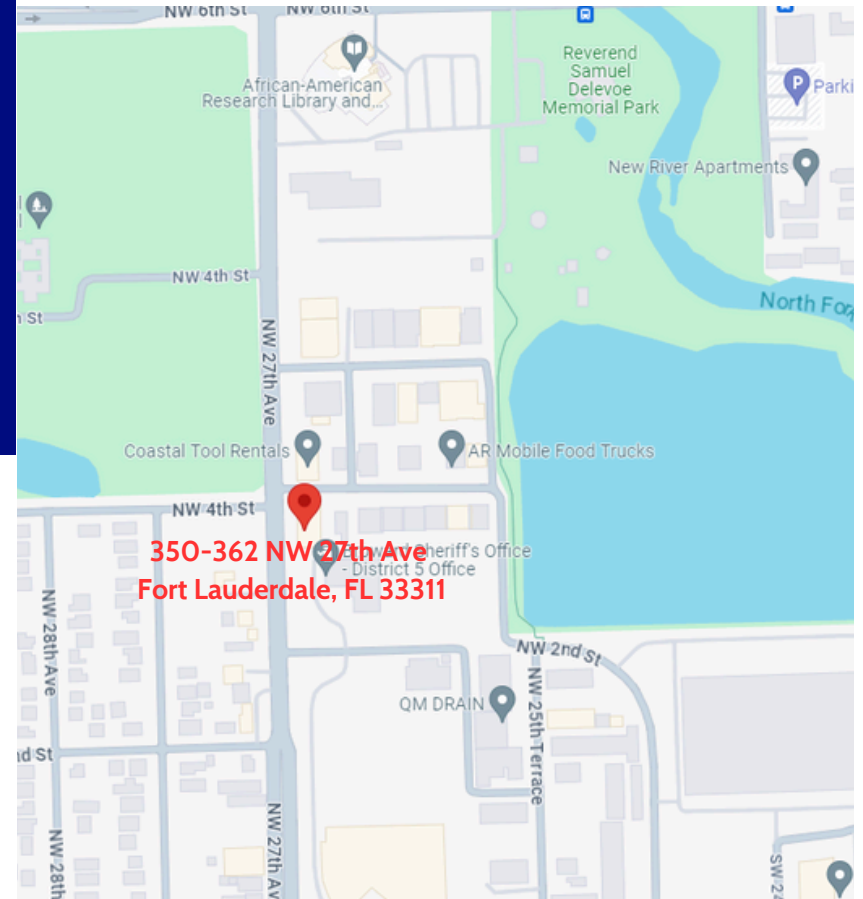





350 352 354 356 358 360 362 364 366 368 370 372 374 376 378 380 382 384 386 388 390 392 394 396 398 400

350 352 354 356 358 360 362 364 366 368 370 372 374 376 378 380 382 384 386 388 390 392 394 396 398 400









# Floor Plan

358 NW 27th Ave  
Fort Lauderdale, FL 33311



Gus Martinez, P.A.  
954.394.7078  
Gus@MartinezTeamCommercial.com



# Site Plan

358 NW 27th Ave  
Fort Lauderdale, FL 33311

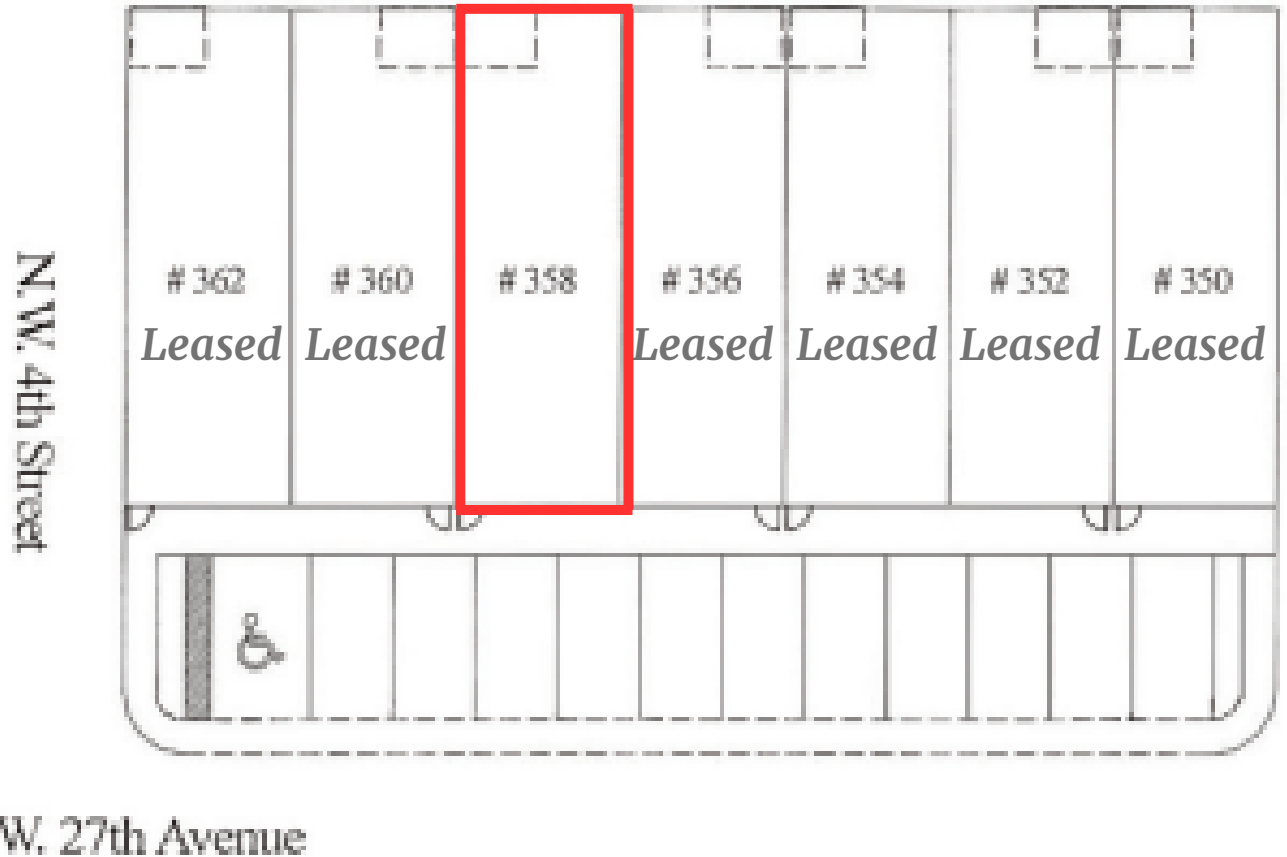



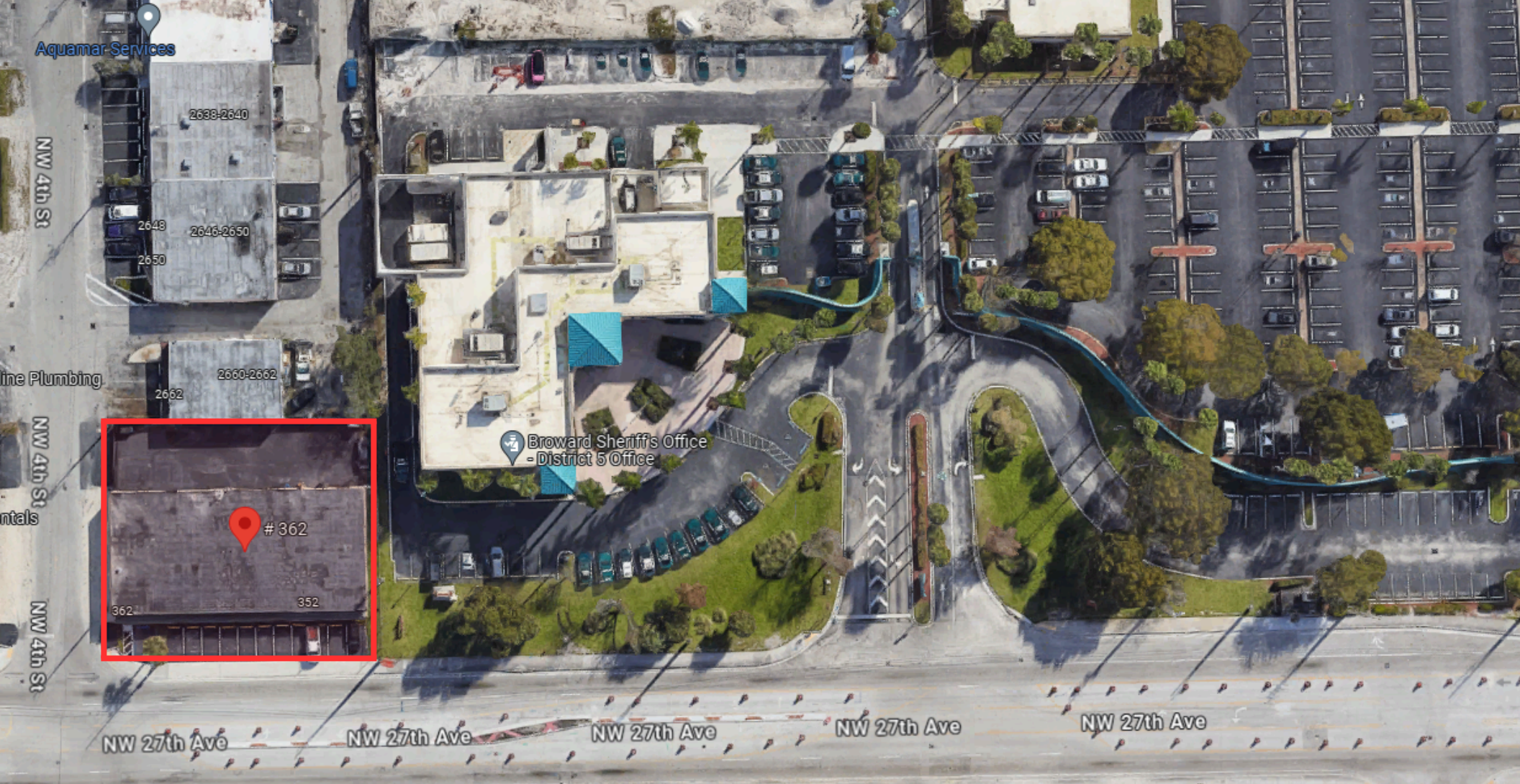

# *Aerial View*

358 NW 27th Ave  
Fort Lauderdale, FL 33311



Gus Martinez, P.A  
954.394.7078  
Gus@MartinezTeamCommercial.com

