



# *Sawgrass International Corporate Park*

1411 Sawgrass International Corporate Parkway  
Sunrise, FL 33323

*For Lease*

[martinezteamcommercial.com](http://martinezteamcommercial.com)

Sawgrass Corporate Park's office spaces host a collaborative community with easy access to all parts of the Broward County. We're home to a diverse group of professionals and entrepreneurs in a variety of industries. We offer fully-furnished workspaces, conference room, kitchen, bathrooms, and reception for your staff and clients. Just bring your laptop and your clients and prepare to do business!



*Office Suite: B-20*

*Available RSF: 180*

*Lease Price:*

*\$800/month*

*Office Suite: B-70*

*Available RSF: 162*

*Lease Price:*

*\$720/month*

*Office Suite: B-90*

*Available RSF: 280*

*Lease Price:*

*\$1,231.20/month*

*Year Built: 2007*

*Building Type: Office/Professional*

*Upgrades: Hurricane Impact Windows & Doors*

## HIGHLIGHTS

- South Florida's largest office park
- Strategically bound by 5-95, I-75, and Sunrise Boulevard
- Mix of high-tech manufacturing, R&D, executive offices suites, and mid-rise Class Offices
- Waterfront

## DEMOGRAPHICS

	2 mile	5 mile	10 mile
2022 Population	29,335	203,477	871,987
2022 Households	10,199	76,884	324,579
Average Household Income	\$110,942	\$105,404	\$87,589

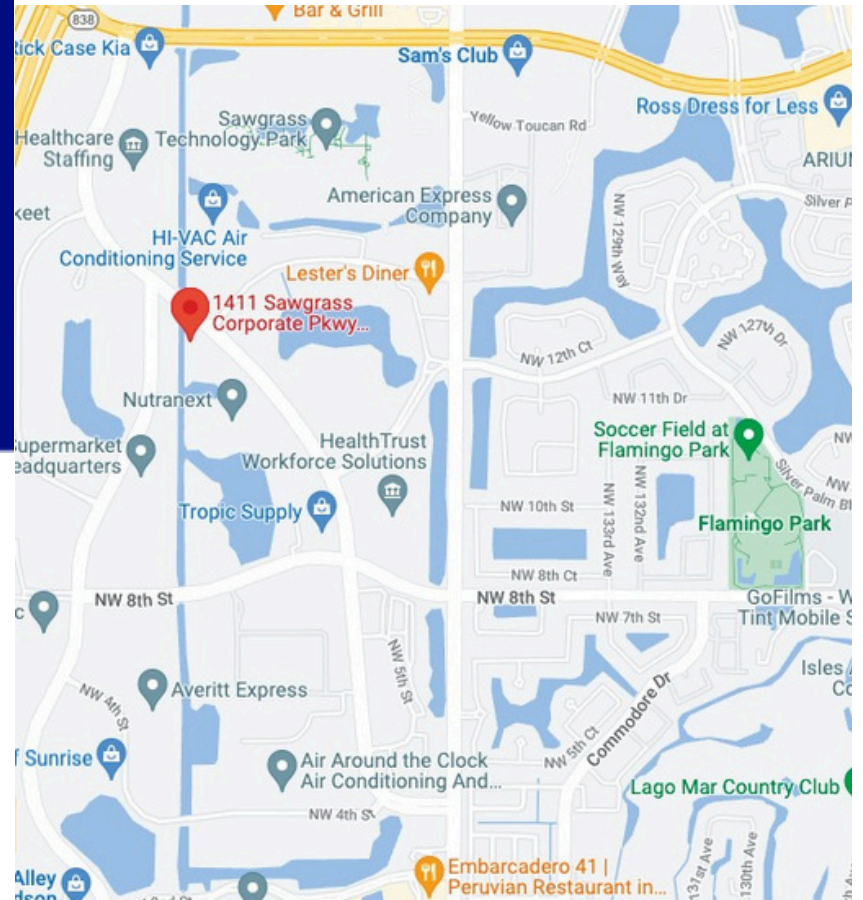

1411 Sawgrass Corporate Parkway  
Sunrise, FL 33323





RESERVED VISION MEDIA

RESERVED VISION MEDIA



# Offices

1411 Sawgrass Corporate Parkway  
Sunrise, FL 33323



# Offices for Lease

*B-20*

180 RSF

*B-70*

162 RSF

*B-90*

280 RSF

1141 Sawgrass Corporate Parkway  
Sunrise, FL 33323

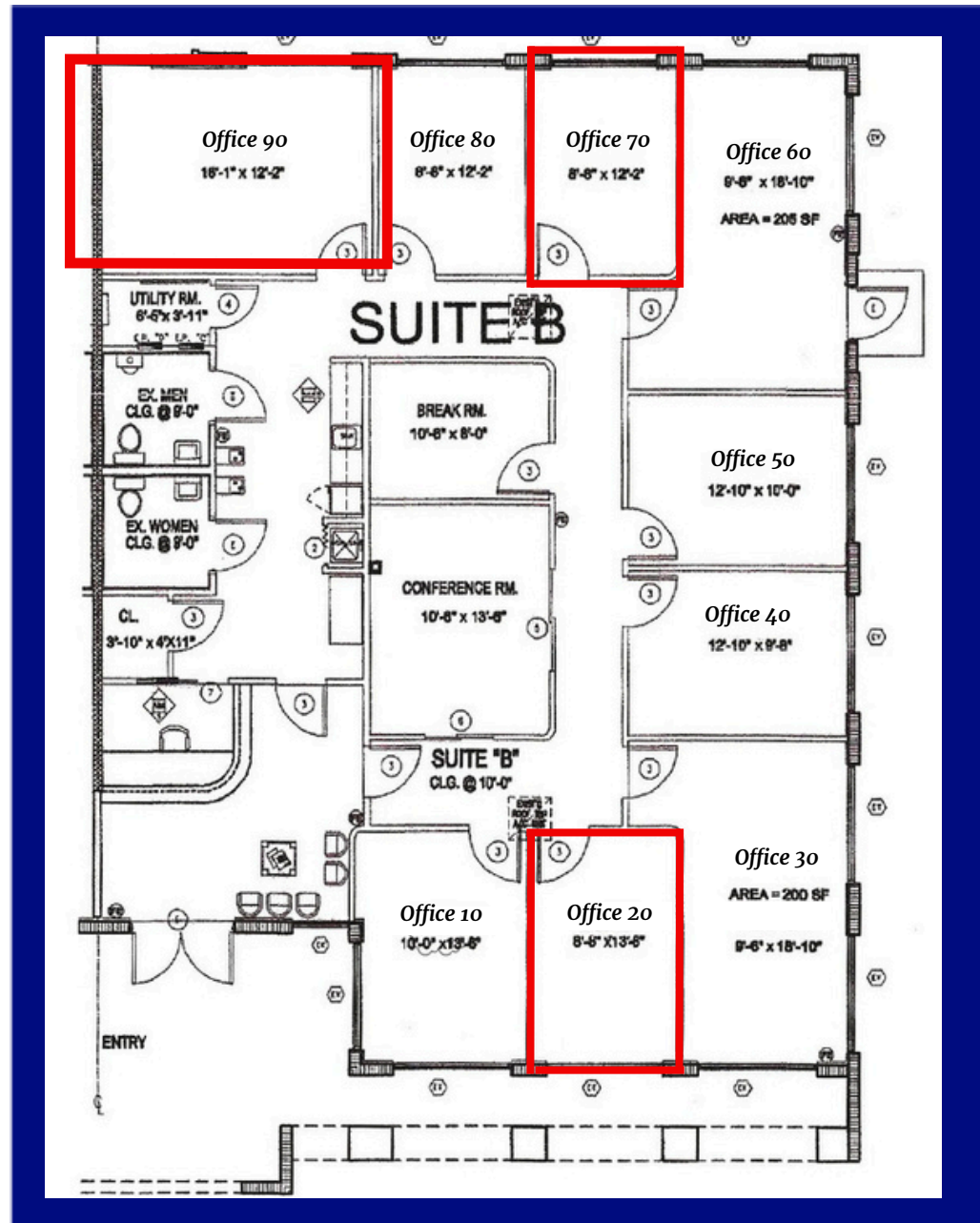

Gus Martinez, P.A.  
954.394.7078  
GusMartinez@KW.com

